

ATTENTION: Before taking your lounge chair apart take the time to label all parts and separate all bolts & hardware. This will ensure easier assembly in the future. Note that left and right is while you are seated in the chair.

Tools needed: A large #3 and a medium #2 Phillips screwdriver.
A 5/32 hex bit may be needed for the newer lounge chair arms that use a hex screw.

1. Remove the cushions:

The two back cushions have a snap located at the bottom (center), one inch above the cushion's edge. The old style cushions have 2 snaps. One is at the top edge (center) and one is at the bottom edge (center). Unsnap the snap and slide the cushions upward approximately three inches. Set them aside noting which is top and which is bottom.

The seat cushion has a snap on the back edge (center). The old style cushions have 2 snaps. One is at the front edge (center) and the other is at the back edge (center). Unsnap the snap(s) and pull the cushion toward you if you are facing the chair. Or, if you are at the back of the chair push it away from you and out of the chair.

2. Use a #3 Phillips screwdriver to remove the two screws that secure the top of the two back supports (#11). Then remove the four screws in the lower back supports (two per side), and set aside the back brace and spacers.

3. Use a #2 Phillips screwdriver to remove the screws (two per side), that secure the arm pads (#6) to the seat panel. Be careful not to rest the shaft of the screwdriver against the wood. With arms removed, the connector plate (#8) and the rubber shockmounts will be exposed. Remove the connector plate from the seat panel (#5) by removing the screws. (newer chairs use hex screws so a 5/32 hex bit tool is needed).

4. Remove the spider/base assembly (#2 & 4) by removing the four screws that secure it to the underside of the seat panel.

Important Packing & Shipping Instructions

All panels need to be individually labeled with clients name and Hume estimate number. Panels received unlabeled will not be repaired. Panels should be individually packaged using bubble wrap. Packing Peanuts are not allowed, boxes received containing such material will incur a \$20 disposal charge. Do not include additional parts eg. arm angle brackets with your panels. Hume is not responsible for the loss of additional parts. Repair parts should be sent via UPS Ground with insurance in a 28" x 28" x 16" box (approx.) to:

humemodern - 5614 Venice Blvd Los Angeles CA 90019

Assembly Procedures for the Eames® Lounge Chair

- Place the seat pan upside down with the off center holes closest to the edge facing you. (This is the backside of the seat pan.)
- The long fingers of the spider should point up (to the front of the chair). Insert screws through washers loosely for proper hole alignment, and then tighten down all screws.
- Turn base and seat right side up.
- Hold connector plate with the short, curved side up. Arm pad (top) holes should be off center and left, (for the right side of the chair in use). Arm pad holes go forward. The seat pan connects to the first two holes. Insert shockmount screws approximately half way.
- Hold connector plate with the short angle up and arm pad holes (top) offset to the right, (for the left side of chair). Arm pad holes forward. Insert shockmount screws half way.
- To connect the lower back panel to the seat pan. Insert screws through connector plates and into the shockmounts located on sides of the seat pan. Insert all shockmount screws loosely at first until all are in place.
- Now tighten down all shockmount screws.
- Set spacers against lower back panel and line up support bars with holes then secure with screws
- Set spacers against the support bar and attach the upper back panel.
- Attach the cushions to the chair, by starting with the back cushions first. Orient the top cushion with the square corners down. The welting should be flush with the wood. Slide cushion on to engage clips and then snap down button to secure in place. Orient the bottom back cushion with the square corner up. Slide cushion on to engage clips and then snap down button to secure.
- Attach the seat cushion next. Orient the cushion with the snap to the back of the seat pan. It may help to cover the snap with cardboard while hooking the clips. Slide cushion on to engage clips and after all clips are attached then snap down button(s) to secure in place.
- Attach armpads. Orient the armpad with the seam on the edge pointing down to the inside of the chair. The wider end of the pad to the back of the chair. Insert screws into connecting plate and attach armpad. (If the customer has received new arms and the screws do not line up, use a long screw from the base in one hole and insert the short screw in the other hole, then replace the long one with a short one. Repeat for other side. (Newer chairs use hex screws.)

Eames Lounge Chair & Ottoman ES670-1

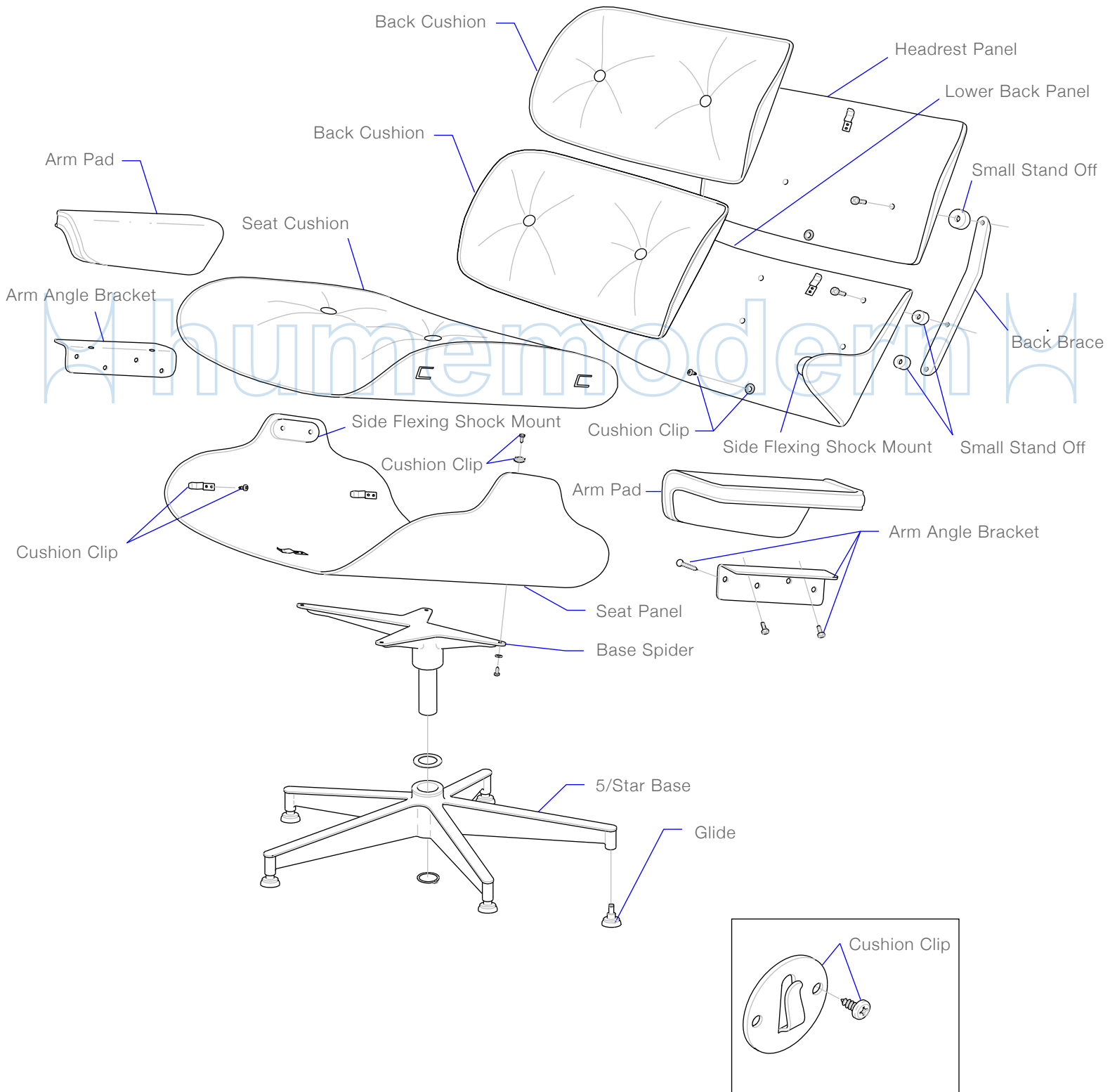

Old style clip, before October 4, 1971